





# +35 YEARS DEVELOPING THINKING ABOUT THE FUTURE

- 1984**  
SINCE
- +26**  
SUCCESSFULL  
PROJECTS
- +600**  
EMPLOYEES
- 520,000**  
M2 BURT
- 135,000**  
M2 UNDER  
CONSTRUCTION
- +84**  
CINEMAS

## +35 YEARS OF EXPERIENCE

For over 35 years, Desarrollo Bahia has led the real estate development of Panama City. With each project, he has sought to reinvent himself by investing in the future.

The company refuses to settle for traditional projects; it has a truly rich and diverse portfolio of more than 360,000m2 built and another 160,000m2 under construction between residential and commercial projects, cinemas, shopping centers and hotels, which make it a pioneer in the world of real estate and construction, naturally establishing new standards in the industry.



Panama City 1965

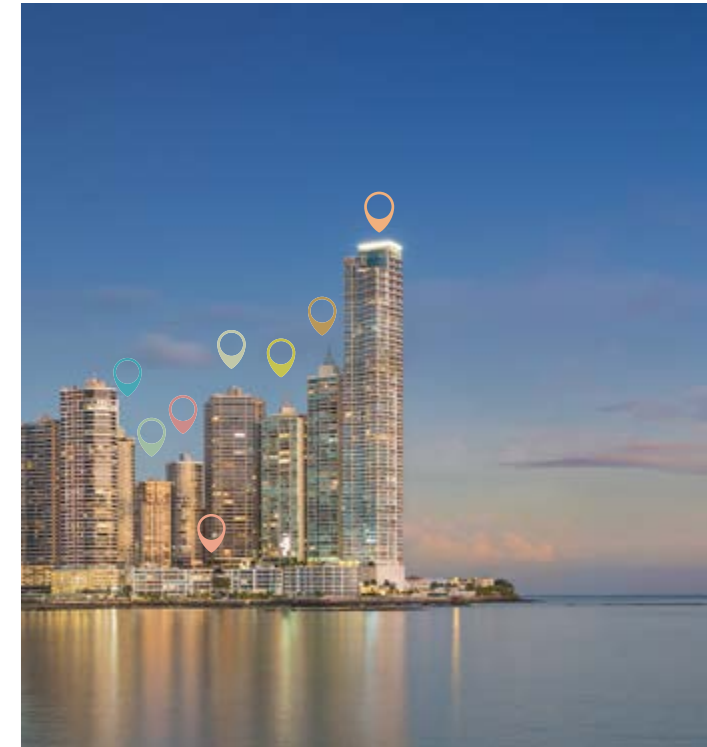

Panama City 2018



## CALLE 50

**56**

Levels

From **101m<sup>2</sup>** to **1,124 m<sup>2</sup>**

**66**

Parking spaces

**6**

Elevators



5 min walking  
distance from  
subway station





1989  
Mediterrané

The beginning of a dream that today takes more than 30 years. Mediterrané was our first project under construction, at the time, one of the highest towers in Panama.



1996  
Villa Marina



1998  
Hotel Marriott Panama

Desarrollo Bahía sets foot in the hospitality world, marking the difference with the first luxurious hotel, the first Marriott in the country.



2003  
Bahía Pacifica



2008  
C.C. Multiplaza Pacific

Introducing ourselves into the commercial world, we became part of the construction of the most luxurious, largest and recognized shopping mall in the country.



2011  
VIP Multiplaza

4 Cinemas

Always focused on luxury, we arrive in Panama with the first VIP cinema room with leather seats, bar / restaurant and personalized attention.



2012  
Miradores



2013  
Cinepolis Westland mall

8 cinemas



2015  
Financial Park

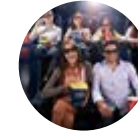

2016  
Cinepolis Los Andes Mall

6 cinemas



2017  
Cinepolis Town Center

3 cinemas VIP  
5 cinemas



The Regent  
Under construction.



# +35 YEARS OF EXPERIENCE



1993  
Mar de Plata



1998  
Plaza Banco General

First luxury office tower in the city, located where all businesses are centered, the banking area.



2002  
Península



2004  
Punta Roca



2008  
Cinepolis MP

10 cinemas

Cinépolis arrives to Panama from the hand of Desarrollo Bahía. First Cinema room with the latest technology screens in the country.



2011  
Cinepolis Metromall

10 cinemas



2012  
The Point

One of the most iconic tower at Panama skyline. Awarded by Carmes as the highest residential project in Latin America.



2012  
Tower Financial Center

Luxury and business merge into one of the most elegant and iconic towers in Panama City, the TowerBank Tower.



2014  
Country Club



2015  
Cinepolis VIP Soho Mall

7 cinemas



2017  
Cinepolis Dorado Mall

9 cinemas



The Tower

Under construction



Skyline

Under construction

# PANAMA CITY

Panama city its a magical place with with an important cultural mixture. In a few years it has managed to become in a city with a cosmopolitan life, a combination of History, modernity, the international and local culture. One of its main attractions is its beautiful and bright horizon where Desarrollo Bahia took part of its construction.

Taking its location as an advantage. Panama has developed a transport and communication network without comparisson and the Panama Canal is included , it is one of the most active portuary complexes in Latin America and the second most important free zone in the world. The country's economy has reached a growth rate that has positioned it in one of the top positions in the latin american region.

This can be attributed to its location at the heart of the growing latin american market, wich has converted Panama in a business operation center around the globe.





## PRIVILEGED POSITIO

Tower Financial Center is located at the beginning of calle 50, one of the city's main veins and one of the most strategic zones of Panama City due to its proximity to the bank area and Marbella, a place where great companies and commerces are located.



ELEGANT LOBBY  
REAL PICTURE

A GREAT BUSINESS DESERVES TO  
BE IN A ICONIC TOWER









## OFFICE

**1224m<sup>2</sup>**

- 1 Office per floor
- Open spaces without columns
- Beautiful panoramic view to the sea
- Luxurious finishes
- 8 high speed elevators

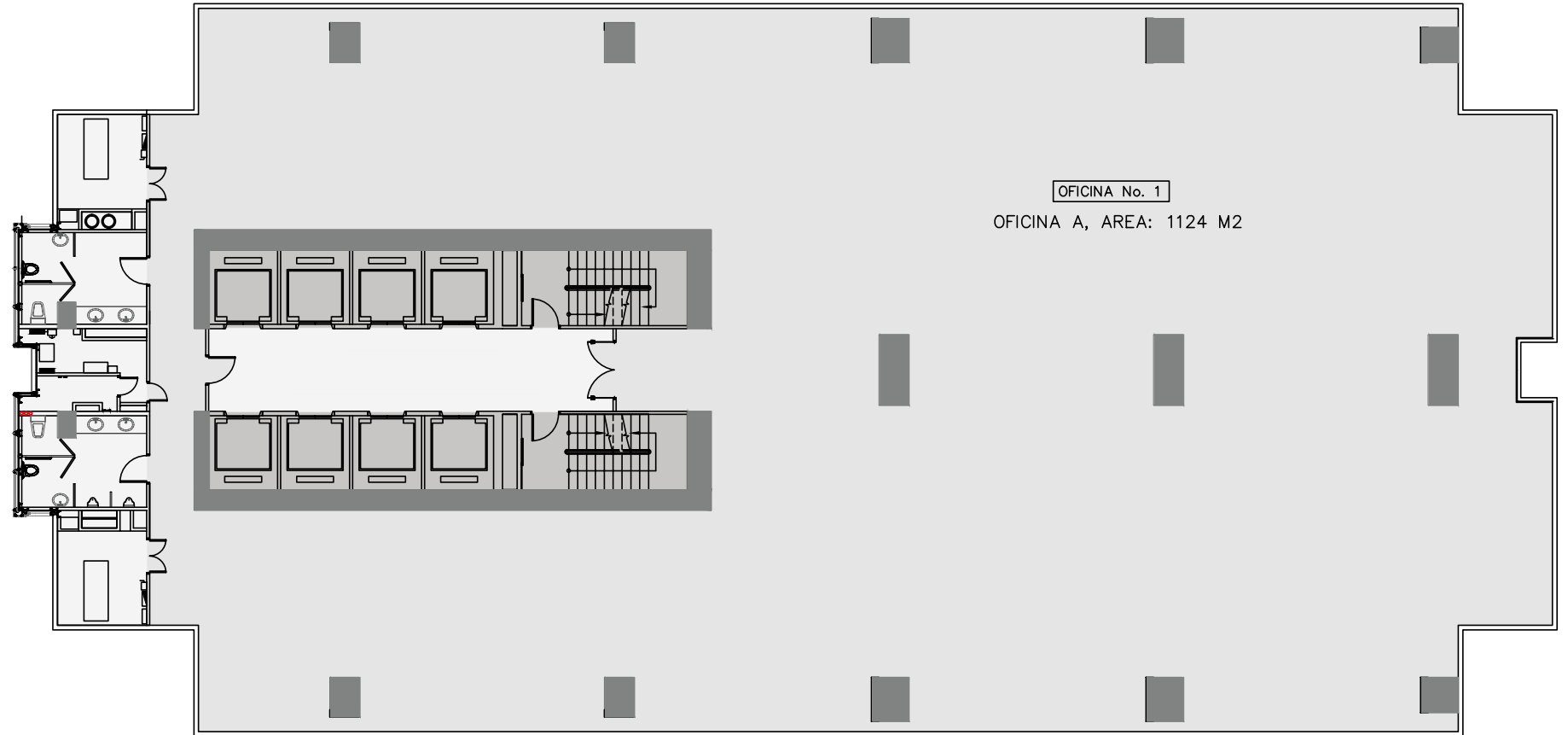



OFFICES  
562m2

- 2 offices per floor
- Open spaces without columns
- Beautiful panoramic view to the sea
- Luxurious finishes
- 8 high speed elevators

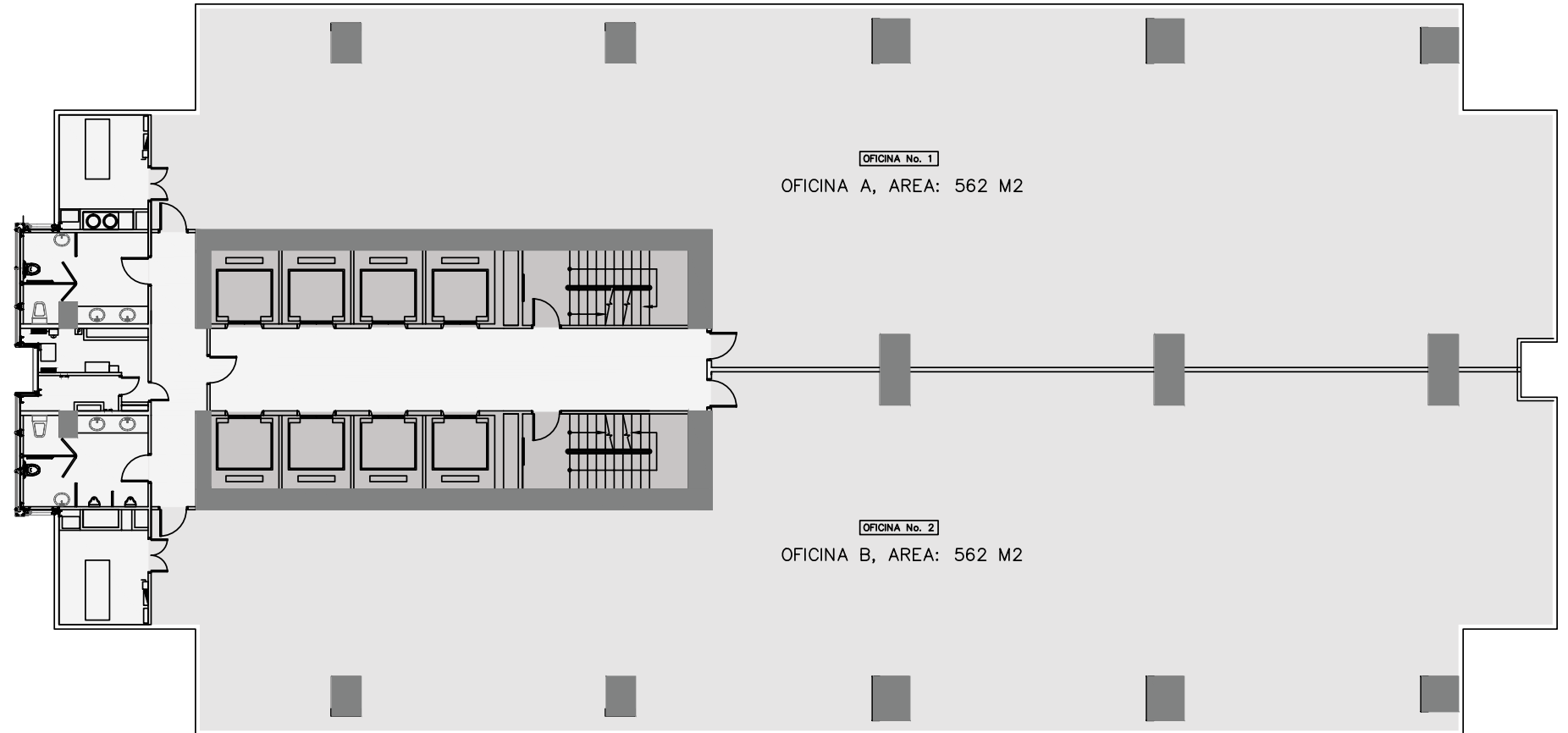



OFFICES  
202m2 • 360m2

- 4 offices per floor
- View of the sea or city
- Luxurious finishes
- 8 high speed elevators

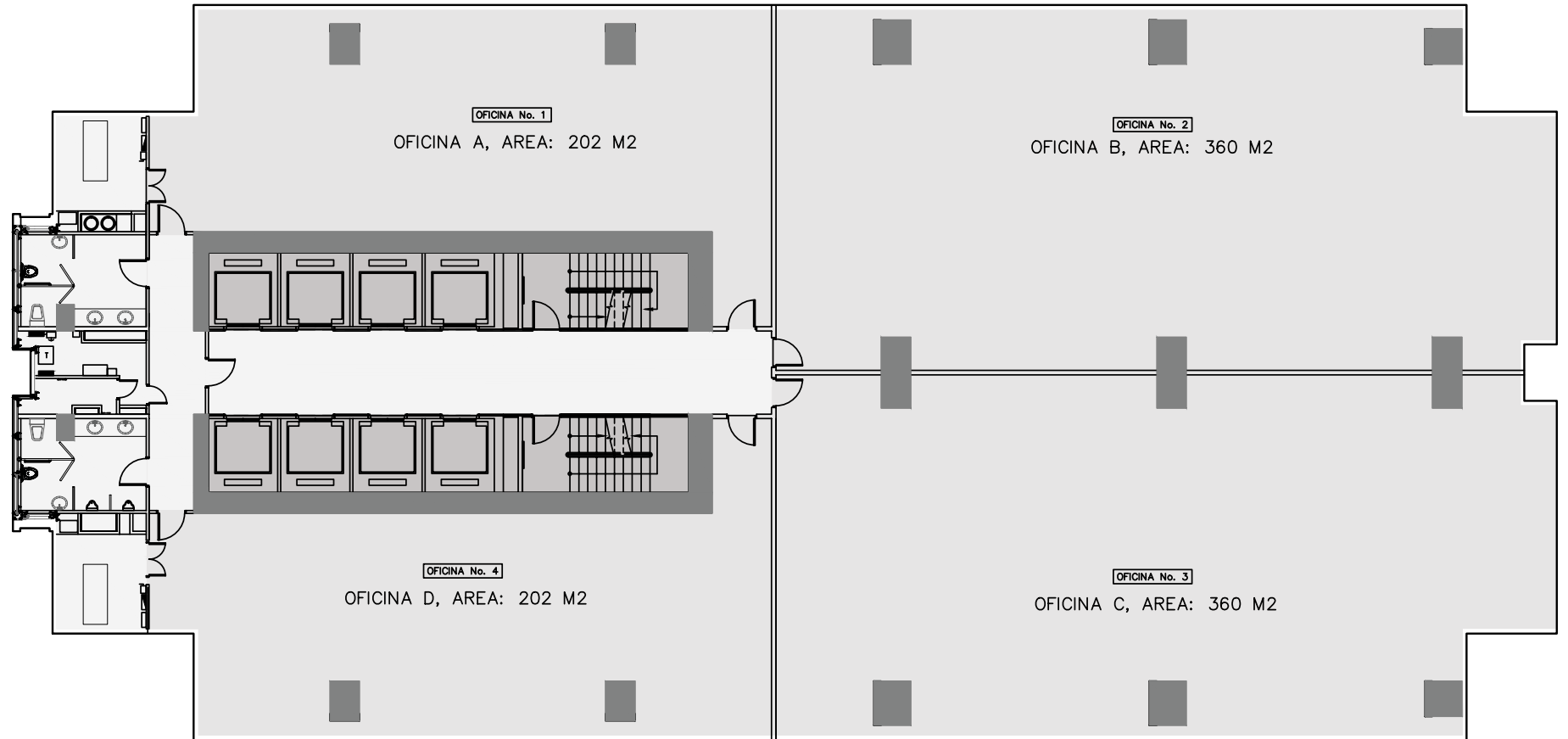





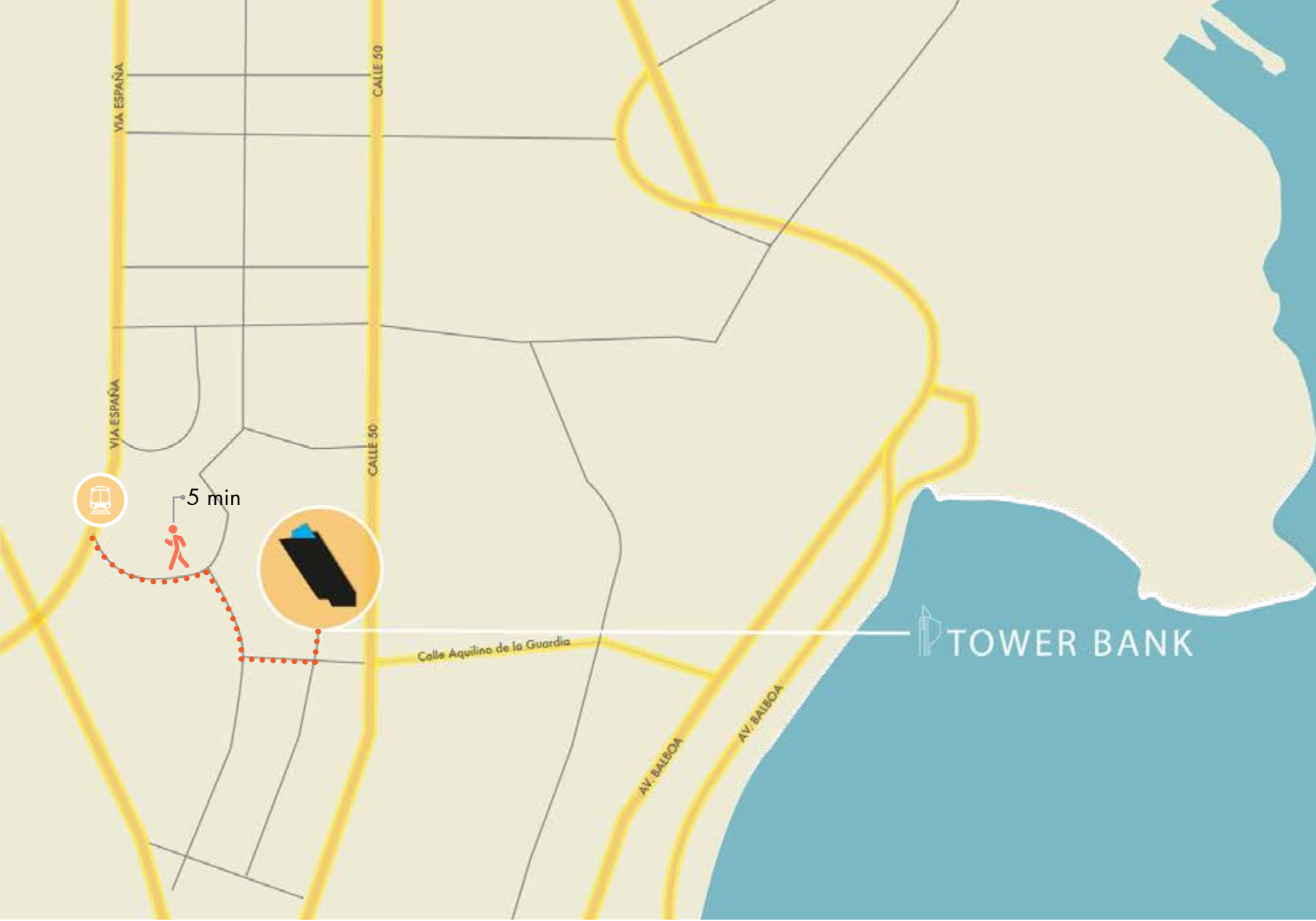

## PRIVILEGED LOCATION

Tower Financial Center is located at the beginning of calle 50, one of the city's main vein and one of the most strategic zones of Panama City due to its proximity to the bank area and Marbella, place where great companies and commerces are located.

 TOWER BANK



ALREADY WITH US



AND SO MUCH MORE





+507 214.8888

[ventas@desarrollobahia.com](mailto:ventas@desarrollobahia.com)

[www.DesarrolloBahia.com](http://www.DesarrolloBahia.com)



YOU DESERVE  
**LUXURY**